

# **XE** AERO

BOLD . STRONG . THE FUTURE

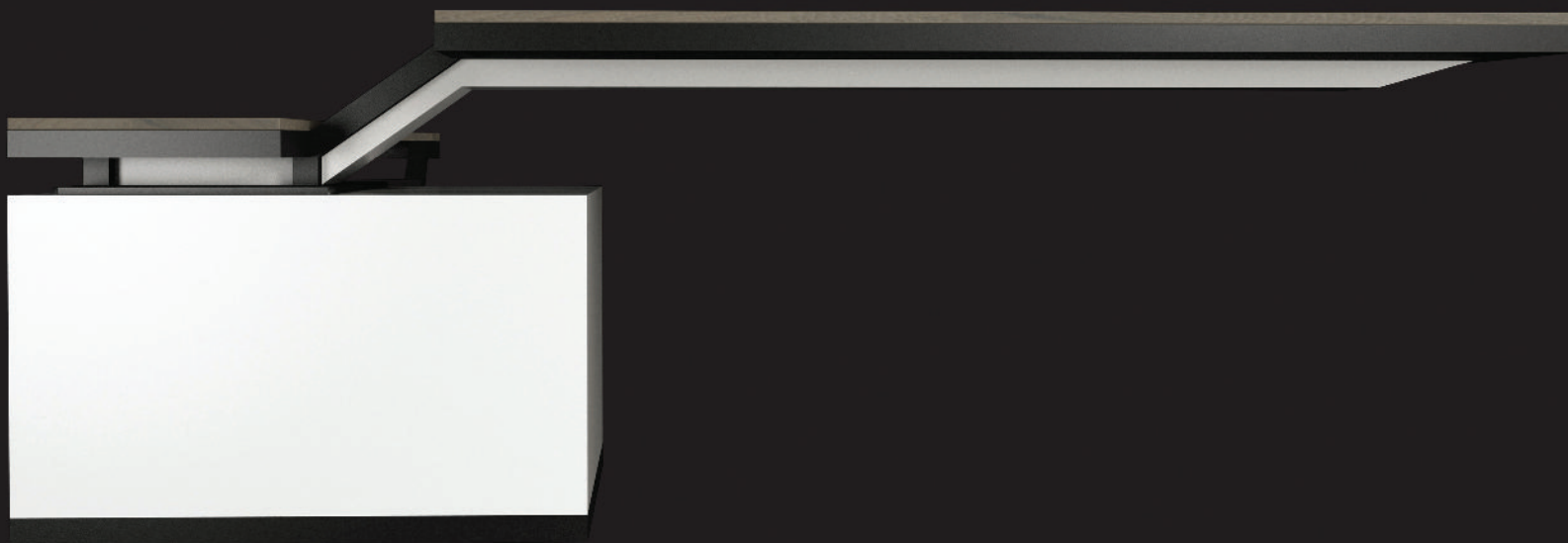

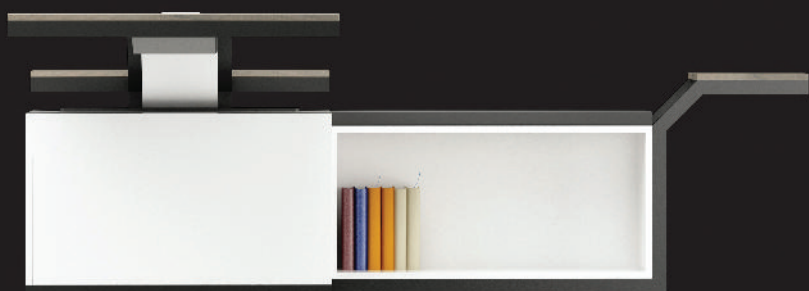

DESIGNED BY JOSEPH YEAP

XE AERO COMBINES  
ELITE, LIGHTWEIGHT AND  
FUTURISTIC DESIGN WITH  
EFFICIENCY AND  
FUNCTIONALITY.

- supreme cable management
- hidden structure for floating effect
- integrated ventilation system
- sliding socket with wireless charger
- optional cushion

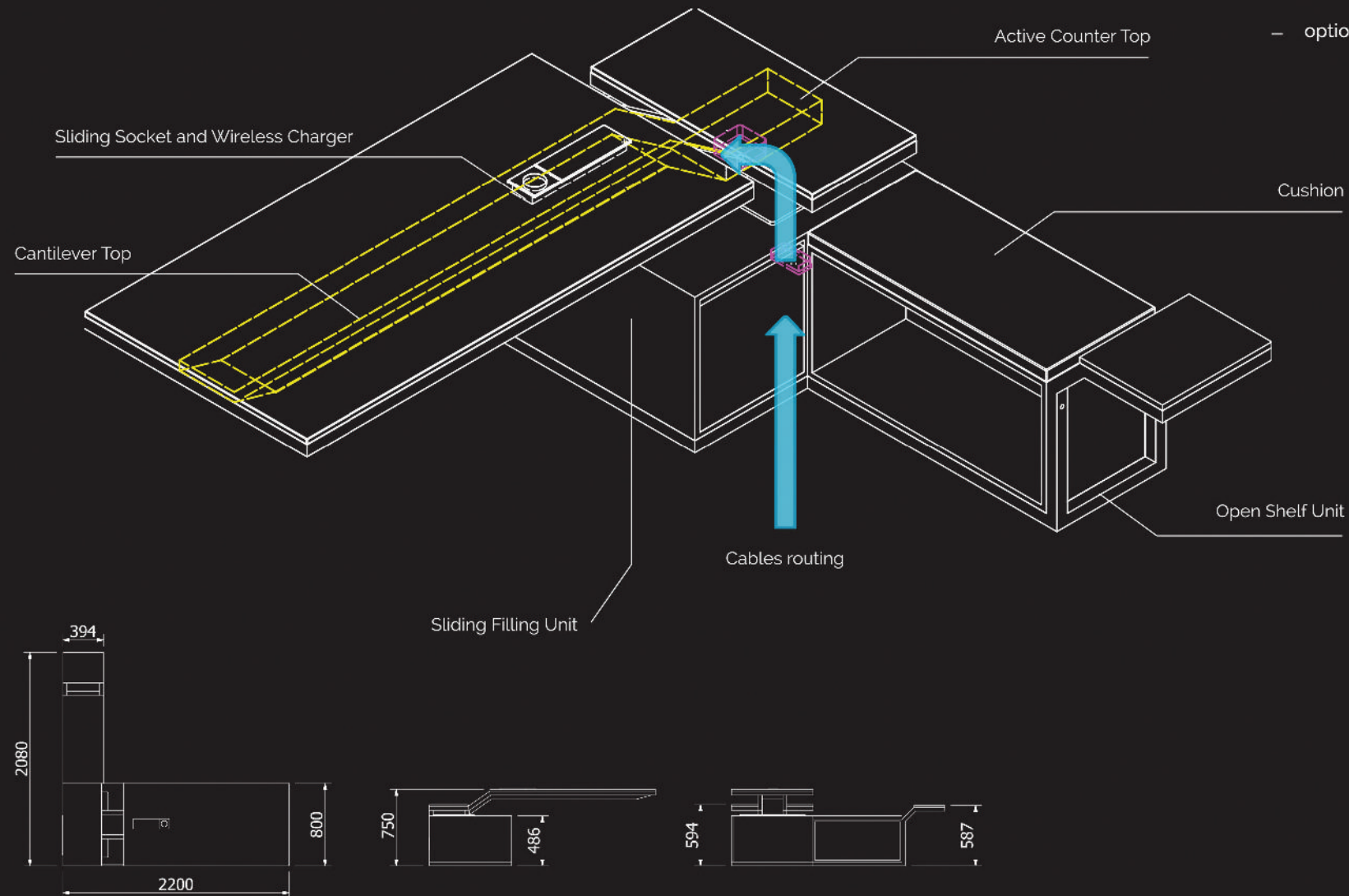



## SPECIFICATIONS



### Structural Frame :

Made from steel construction material AISI steel grades. I-shape cross section have high second moments of area, which allow them to be very stiff in respect to their cross-sectional area.

### Worktops :

25 mm thick European E1 grade melamine / laminate board with 3mm thick Impact resultant PVC edging. Finishes are scratch and abrasion resistant with a minimum density of 620 kg/mc $\pm$  5%.

### Steel Component :

All steel components are treated and powder coat to a minimum 50 microns. (with environment friendly materials)

### Worktops Finishes :

Standard worktop finishes are available in melamine or laminate.

## FINISHES



SU 793W  
Alabaster Oak

764M  
Barocco Walnut EM

QDA 43005FG  
Brown Santana Oak



316  
White Buche

325  
Maple

FR77G4  
Megabyte

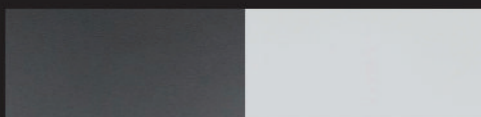

201  
Graphite Grey

203  
Light Grey

## ORDERING CODE

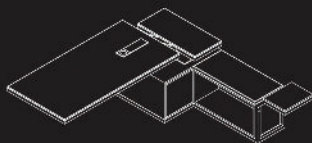

XE-AEROWEER2003  
-WL-LM/ML-R

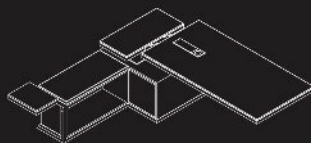

XE-AEROWEER2003  
-WL-LM/ML-L