

EX

EXECUTIVE SERIES

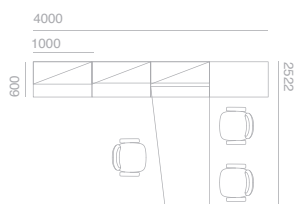

Minimalist architecture with contemporary finishes. Balance is the key when it comes to aesthetics and functionality. The EX series offers versatility in configuration and style, defines space and spurs individuality. The chic and exquisite EX storage attunes to the modern office.



Worksurface Dark Grey (ML)
Table Support Polished Aluminium
Storage English Oak (LM)



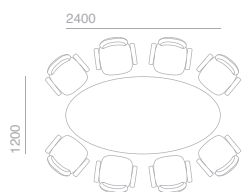

Worksurface Zebra Yoko (LM)
Table support Brushed Stainless Steel

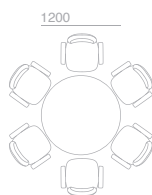

Worksurface English Oak (LM)
Table support Brushed Stainless Steel

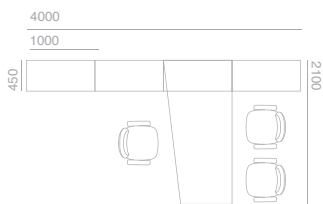

Worksurface Zebra Yoko (LM)
 Table support Brushed Stainless Steel
 Storage Zebra Yoko (LM), Dark Grey (ML)

1. Simple stack-on storage with minimal configuration. Available in various sizes and two types to choose from; the swing door and open shelf.
2. The drawer unit features detailed storage space and functionality. It gathers documents in the internal drawer and allows the hanging of A4 and foolscap sized lateral files.
3. The A.H. Meyer outlet unit for power voice and data is stowed neatly from sight but easily accessible. It comes in various numbers and types of outlets to choose from, dependent on requirements. Smart and neat design whilst ensuring safety and quality.

Stack-on modular storage creates a landscape of varying height levels. Storage options of 1 drawer, 2 drawers, swing door and open shelf are available to support users' preferences and functionality. Trapezium-shaped tabletops of different sizes adds dynamism to the linear layout.

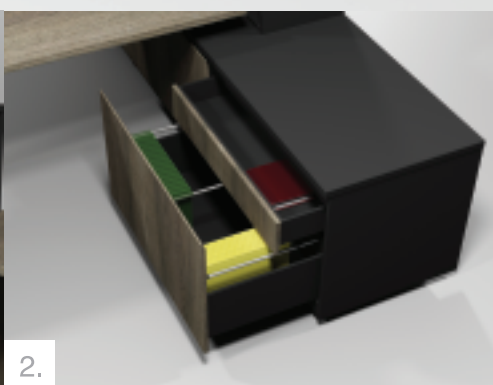

Diversity in style and feel can be created with the right colour combination to accommodate users' preferences- the white and light tones for a lively and easy-going feel, or the dark and heavier tones for a more classic look. Select from a range of premium finishes, available in solid colours or wood grain. Finely polished aluminum legs or stainless steel base enhances and compliments the image.

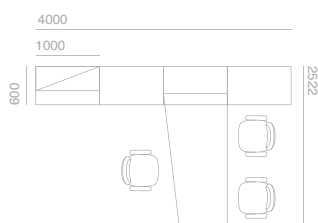

Worksurface Rovere Oak (ML)
Table Support Brushed Stainless Steel
Storage Rovere Oak (ML), White (ML)



Finishes



101 White ML

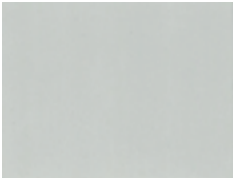

203 Light Grey ML

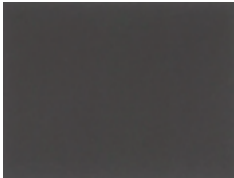

201 Dark Grey ML



E9SM Rovere Oak ML



JB1034T English Oak LM

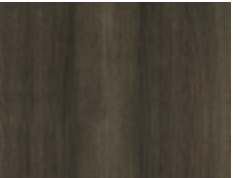

JW7003HL Zebra Yoko LM

Technical Specifications

Storages

Are made of 18mm and 30mm thick melamine-faced chipboard using KD fittings. Optional soft-closing feature for drawers and swing doors is available.

Drawers

Filing drawers can fit A4 and Foolscap size hanging file. It has full extension, ball bearing slides.

Melamine Faced Chipboard

18mm and 30mm thick European E0 grade melamine-faced particle board with impact resistant 3mm PVC edging.

Worktops

All worktops, depending on finish, come in either 25mm thick MDF or 30mm thick particle board. E0 grade board is available upon request.

Steel Components

Tabletop spacer is made of steel, which is treated and powder coated to a minimum of 50 microns. The round base table support is made of stainless steel with brushed finish.

Table Legs

Moulded from (Aluminium Die Castings) ADC-12 with satin polished.

Product Codes

Meeting Table

Reverse waterfall edging work surface, including round base table support.

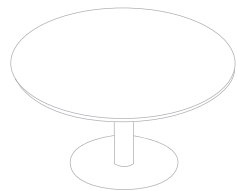

EX-RMW09-RW1-FSU-ML/LM
EX-RMW10-RW1-FSU-ML/LM
EX-RMW12-RW1-FSU-ML/LM

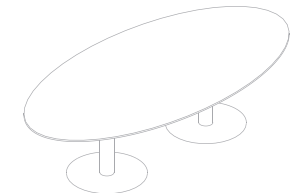

EX-OVMW189-RW1-FSU-ML/LM
EX-OVMW2110-RW1-FSU-ML/LM
EX-OVMW2412-RW1-FSU-ML/LM

Tabletop

To be used with 450 depth cabinet

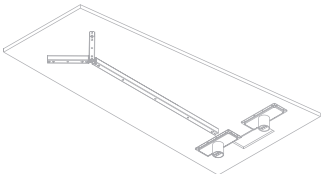

EX-X4YTW181007SP-TD3012-L/R-ML
EX-X4YTW211007SP-TD3012-L/R-ML
EX-X4YTW241007SP-TD3012-L/R-ML
EX-X4YTW1897SP-TD3012-L/R-ML
EX-X4YTW2197SP-TD3012-L/R-ML
EX-X4YTW2497SP-TD3012-L/R-ML

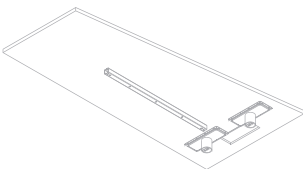

EX-UTZW181007SP-TD3012-L/R-ML
EX-UTZW211007SP-TD3012-L/R-ML
EX-UTZW241007SP-TD3012-L/R-ML
EX-UTZW1897SP-TD3012-L/R-ML
EX-UTZW2197SP-TD3012-L/R-ML
EX-UTZW2497SP-TD3012-L/R-ML

To be used with 600 depth cabinet

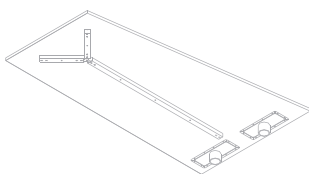

EX-X4YTW181007D600SP-L/R-ML
EX-X4YTW211007D600SP-L/R-ML
EX-X4YTW241007D600SP-L/R-ML
EX-X4YTW1897D600SP-L/R-ML
EX-X4YTW2197D600SP-L/R-ML
EX-X4YTW2497D600SP-L/R-ML

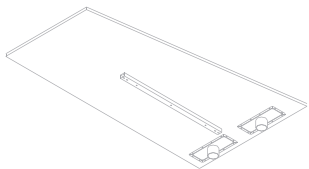

EX-UTZW181007D600SP-L/R-ML
EX-UTZW211007D600SP-L/R-ML
EX-UTZW241007D600SP-L/R-ML
EX-UTZW1897D600SP-L/R-ML
EX-UTZW2197D600SP-L/R-ML
EX-UTZW2497D600SP-L/R-ML

Table Support

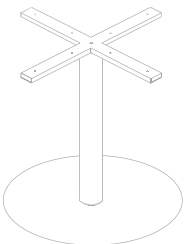

EX-TLRB-C76-SS

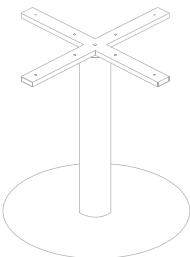

EX-TLRB-C102-SS

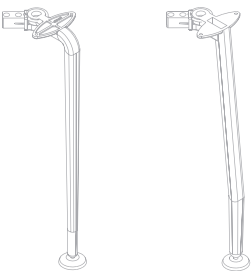

X4-TSLEGVE

X4-TSLEG

Product Codes

Cabinet

2 drawers cabinet

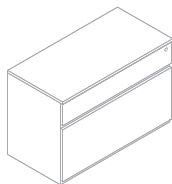

450 depth
H = 600, W = 600/ 750/ 900/ 1000
EX-CL2-6006045T30NH-ML/LM
EX-CL2-6007045T30NH-ML/LM
EX-CL2-6009045T30NH-ML/LM
EX-CL2-60100045T30NH-ML/LM

600 depth
H = 600, W = 600/ 750/ 900/ 1000
EX-CL2-600606T30NH-ML/LM
EX-CL2-600706T30NH-ML/LM
EX-CL2-600906T30NH-ML/LM
EX-CL2-6010006T30NH-ML/LM

With mounting hole for storage
EX-CL2H2-600606T30NH-ML/LM
EX-CL2H2-600706T30NH-ML/LM
EX-CL2H2-600906T30NH-ML/LM
EX-CL2H2-6010006T30NH-ML/LM

Swing door cabinet

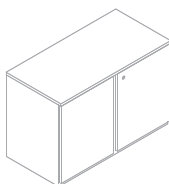

450 depth
H = 600, W = 600/ 750/ 900/ 1000
EX-CD2-6006045T30NH-ML/LM
EX-CD2-6007045T30NH-ML/LM
EX-CD2-6009045T30NH-ML/LM
EX-CD2-60100045T30NH-ML/LM

With mounting hole for tabletop
EX-CD2H-6009045T30NH-ML/LM
EX-CD2H-60100045T30NH-ML/LM

600 depth
H = 600, W = 600/ 750/ 900/ 1000
EX-CD2-600606T30NH-ML/LM
EX-CD2-600706T30NH-ML/LM
EX-CD2-600906T30NH-ML/LM
EX-CD2-6010006T30NH-ML/LM

With mounting hole for storage
EX-CD2H2-600606T30NH-ML/LM
EX-CD2H2-600706T30NH-ML/LM
EX-CD2H2-600906T30NH-ML/LM
EX-CD2H2-6010006T30NH-ML/LM

Open shelf cabinet

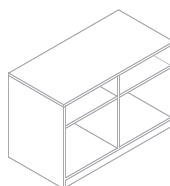

450 depth
H = 600, W = 600/ 750/ 900/ 1000
EX-COF-6006045T30-ML/LM
EX-COF-6007045T30-ML/LM
EX-COF-6009045T30-ML/LM
EX-COF-60100045T30-ML/LM

With mounting hole for tabletop
EX-COFH-6009045T30-ML/LM
EX-COFH-60100045T30-ML/LM

600 depth
H = 600, W = 600/ 750/ 900/ 1000
EX-COF-600606T30-ML/LM
EX-COF-600706T30-ML/LM
EX-COF-600906T30-ML/LM
EX-COF-6010006T30-ML/LM

With mounting hole for storage
EX-COFH2-600606T30-ML/LM
EX-COFH2-600706T30-ML/LM
EX-COFH2-600906T30-ML/LM
EX-COFH2-6010006T30-ML/LM

With netbox turn 4 gang and
mounting hole for tabletop
EX-COFH-600606T30-NBT4-ML/LM
EX-COFH-600706T30-NBT4-ML/LM
EX-COFH-600906T30-NBT4-ML/LM
EX-COFH-6010006T30-NBT4-ML/LM

With trapdoor and mounting hole
for tabletop
EX-COFH-600606T30-TD4011-ML/LM
EX-COFH-600706T30-TD4011-ML/LM
EX-COFH-600906T30-TD4011-ML/LM
EX-COFH-6010006T30-TD4011-ML/LM

With netbox turn 4 gang and
mounting hole for storage & tabletop
EX-COFH3-600606T30-NBT4-ML/LM
EX-COFH3-600706T30-NBT4-ML/LM
EX-COFH3-600906T30-NBT4-ML/LM
EX-COFH3-6010006T30-NBT4-ML/LM

With trapdoor and mounting hole
for storage & tabletop
EX-COFH3-600606T30-TD4011-ML/LM
EX-COFH3-600706T30-TD4011-ML/LM
EX-COFH3-600906T30-TD4011-ML/LM
EX-COFH3-6010006T30-TD4011-ML/LM

1 drawer cabinet with internal drawer

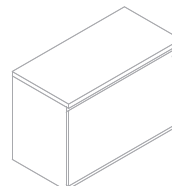

450 depth
H = 600, W = 600/ 750/ 900/ 1000
EX-CL1-6006045T30NH-ML/LM
EX-CL1-6007045T30NH-ML/LM
EX-CL1-6009045T30NH-ML/LM
EX-CL1-60100045T30NH-ML/LM

With mounting hole for tabletop
EX-CL1H-6006045T30NH-ML/LM
EX-CL1H-6007045T30NH-ML/LM
EX-CL1H-6009045T30NH-ML/LM
EX-CL1H-60100045T30NH-ML/LM

600 depth
H = 600, W = 600/ 750/ 900/ 1000
EX-CL1-600606T30NH-ML/LM
EX-CL1-600706T30NH-ML/LM
EX-CL1-600906T30NH-ML/LM
EX-CL1-6010006T30NH-ML/LM

With mounting hole for storage
EX-CL1H2-600606T30NH-ML/LM
EX-CL1H2-600706T30NH-ML/LM
EX-CL1H2-600906T30NH-ML/LM
EX-CL1H2-6010006T30NH-ML/LM

With netbox turn 4 gang and
mounting hole for storage & tabletop
EX-CL1H3-600606T30NH-NBT4-ML/LM
EX-CL1H3-600706T30NH-NBT4-ML/LM
EX-CL1H3-600906T30NH-NBT4-ML/LM
EX-CL1H3-6010006T30NH-NBT4-ML/LM

With trapdoor and mounting hole
for storage & tabletop
EX-CL1H3-600606T30NH-TD4011-ML/LM
EX-CL1H3-600706T30NH-TD4011-ML/LM
EX-CL1H3-600906T30NH-TD4011-ML/LM
EX-CL1H3-6010006T30NH-TD4011-ML/LM

Stack-on Cabinet

Open shelf cabinet

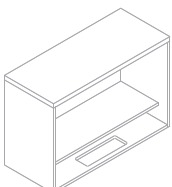

380 depth
H = 600, W = 600/ 750/ 900/ 1000
EX-COF-6006038T30SO-ML/LM
EX-COF-6007038T30SO-ML/LM
EX-COF-6009038T30SO-ML/LM
EX-COF-60100038T30SO-ML/LM

With netbox turn 4 gang
EX-COF-6006038T30SO-NBT4-ML/LM
EX-COF-6007038T30SO-NBT4-ML/LM
EX-COF-6009038T30SO-NBT4-ML/LM
EX-COF-60100038T30SO-NBT4-ML/LM

With trapdoor
EX-COF-6006038T30SO-TD4010-ML/LM
EX-COF-6007038T30SO-TD4010-ML/LM
EX-COF-6009038T30SO-TD4010-ML/LM
EX-COF-60100038T30SO-TD4010-ML/LM

Swing door cabinet

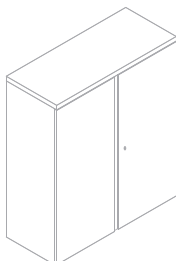

380 depth
H = 1050, W = 600/ 750/ 900/ 1000
EX-CD2-1006038T30NH-ML/LM
EX-CD2-1007038T30NH-ML/LM
EX-CD2-1009038T30NH-ML/LM
EX-CD2-10100038T30NH-ML/LM